



**REQUEST FOR PROPOSAL (RFP) No. PAG-022-002
UNDERWATER ASSESSMENT AND INSPECTION SERVICES**

ADDENDUM No. 1

DATE: MARCH 10, 2022

ALL OFFERORS INTERESTED IN PARTICIPATING IN THIS SOLICITATION MUST ACKNOWLEDGE RECEIPT OF THIS ADDENDUM ON AREA PROVIDED BELOW, AND RETURN COPY OF THIS COVERSHEET TO PAG PROCUREMENT OFFICE.

Fax: (671) 472-1439 or Email: Tamara S. Flores tsflores@portofguam.com, Annie L.G. Sablan algsablan@portofguam.com, Steven P. Muna spmuna01@portofguam.com and Pia Castro pacastro@portofguam.com.

NOTICE TO OFFERORS: Attached are the following documents for the above referenced project:

- 1. Exhibit A & Exhibit B - Piers F-2 to F-6;**
- 2. Exhibit C - Hotel Wharf;**
- 3. Exhibit D - F-1 Pier;**
- 4. Exhibit E - Agana Marina;**
- 5. Exhibit F - Agat Marina;**
- 6. Exhibit G - Aquaworld.**

All others remain the same.

***** END OF ADDENDUM No. 1 *****

Issued by:

LUIS R. BAZA

Acting General Manager

Acknowledgement Receipt

COMPANY NAME: _____

AUTHORIZED SIGNATURE: _____

PRINT NAME: _____

DATE / TIME _____ / _____

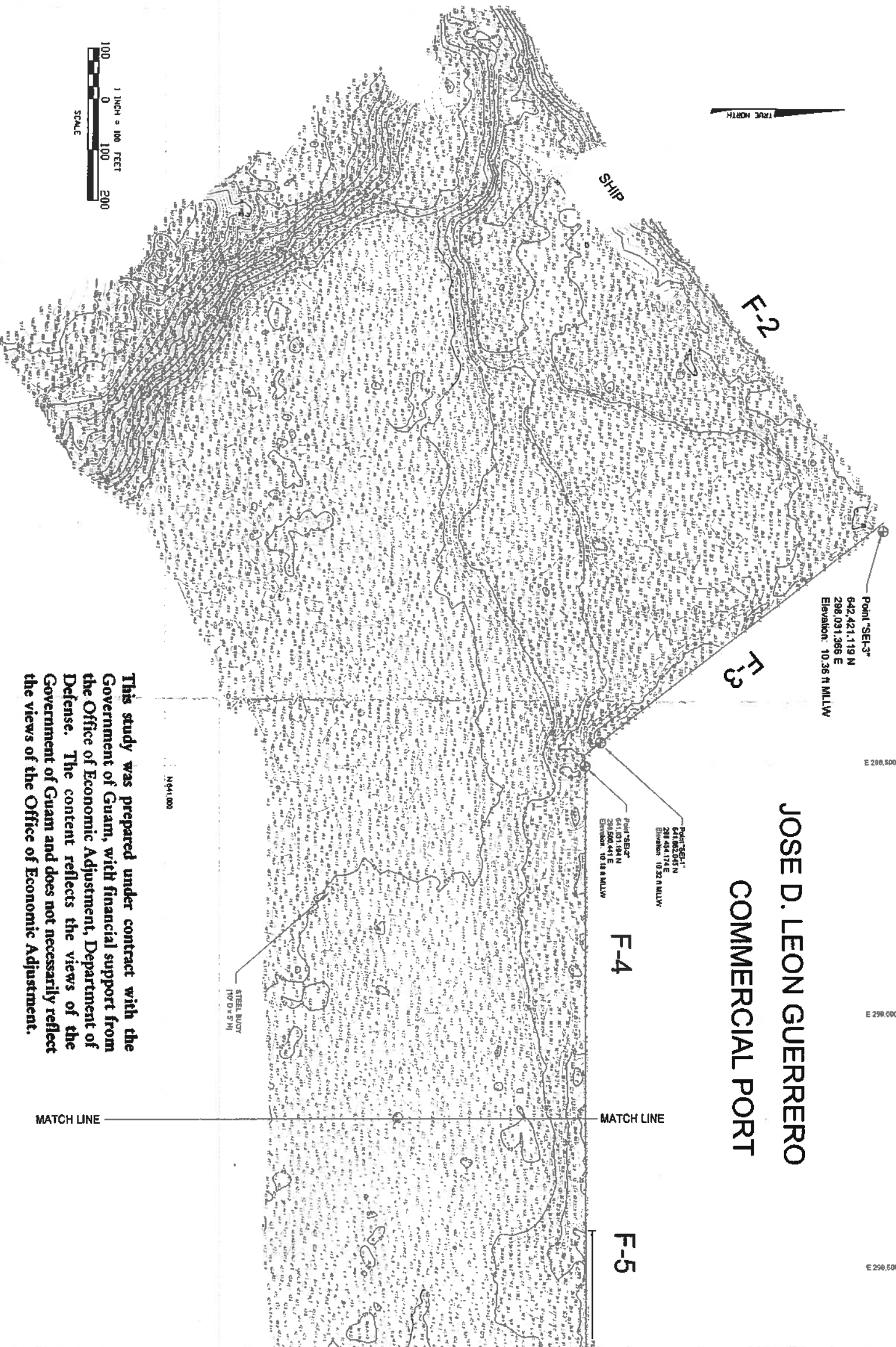

This study was prepared under contract with the Government of Guam, with financial support from the Office of Economic Adjustment, Department of Defense. The content reflects the views of the Government of Guam and does not necessarily reflect the views of the Office of Economic Adjustment.

JOSE D. LEON GUERRERO COMMERCIAL PORT



Sea Engineering, Inc.
MARINE RESEARCHER
400 W. BROADWAY, SUITE 100
DALLAS, TEXAS 75201-2841

KEYNOTES

1. Vertical Datum: MLLW
Soundings in feet
2. Vertical Control:
Point "SEB-1"
Elevation: 10.32 ft MLLW
Point "SEB-2"
Elevation: 10.32 ft MLLW
Point "SEB-3"
Elevation: 10.36 ft MLLW
3. Horizontal Control:
Guam 1983 Coordinate System (Feet)
Point "SEB-2"
641,031.194 N / 298,900.411 E
Point "SEB-1"
642,421.119 N / 298,031.366 E
4. Survey Controls set by
Generations A, Vintadors
Registered Land Surveyor
5. Survey Dates: 05-14-09 and 05-16-09
6. Survey performed to standards of the
U.S. Army Corps of Engineers
Hydrographic Surveying Manual,
EM 1110-3-1003
7. Survey Instrumentation
Ocean Electronic multibeam echo-sounder
C-New GPS positioning
8. Soundings are
a. Averaged over 1-meter (3.28-foot) cells.
b. Sounded by shoalwater method to
Sondec (16.4-foot) radius.

PORT AUTHORITY OF GUAM
Hydrographic Survey
Apra Harbor, Guam
May, 2009
Sheet 1 of 2

REVISIONS		
NO.	DATE	REVISION

**Hydrographic Survey
Contours and Soundings**

DATE: 05/14/09
DRAWN BY: J. G. [unreadable]
CHECKED BY: J. G. [unreadable]
SCALE: 1" = 100'
PROJECT: 2009 Apra Harbor Hydrographic Survey

JOSE D. LEON GUERRERO COMMERCIAL PORT

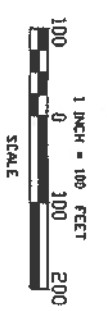
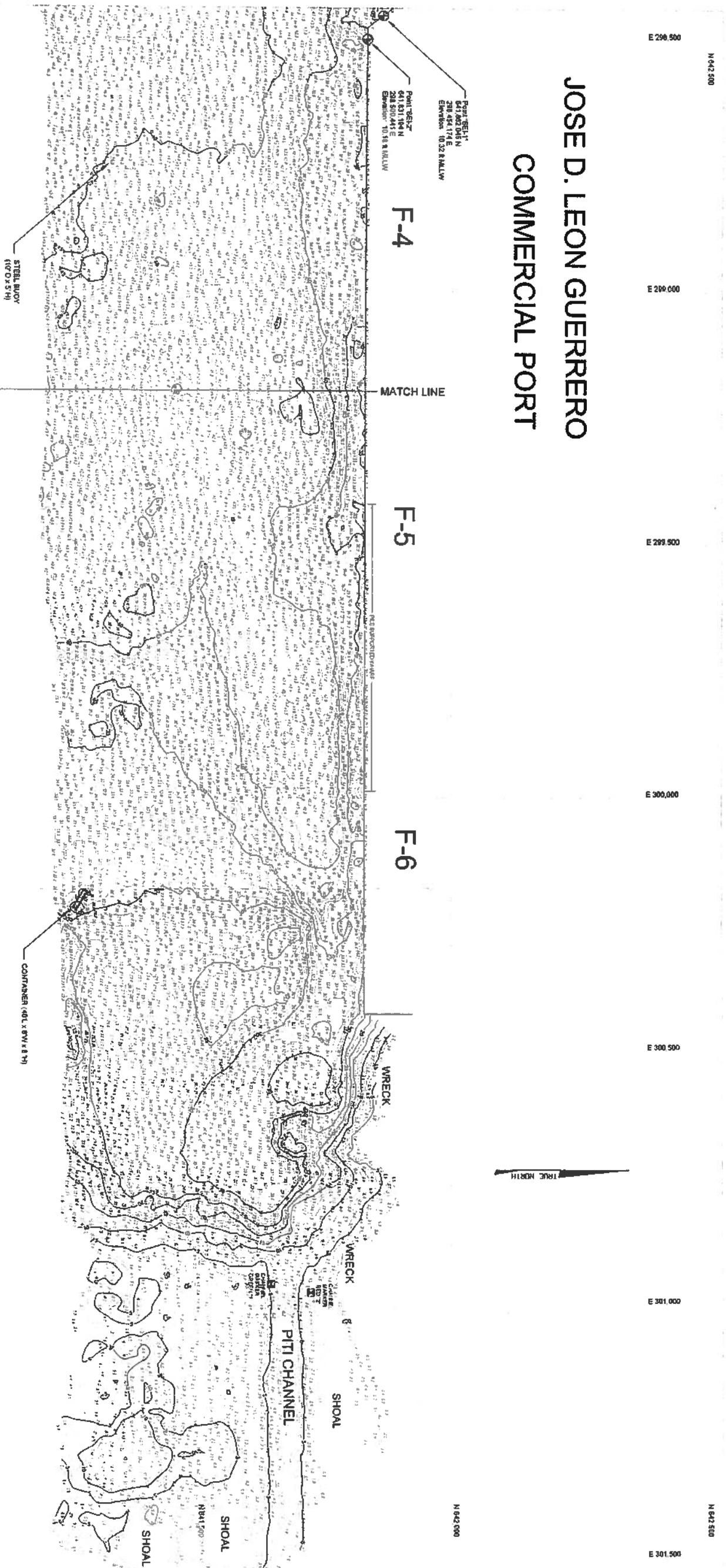

This study was prepared under contract with the Government of Guam, with financial support from the Office of Economic Adjustment, Department of Defense. The content reflects the views of the Government of Guam and does not necessarily reflect the views of the Office of Economic Adjustment.



Sca Engineering, Inc.
HYDROGRAPHIC SURVEY
4001 298-500-441 (PH) 298-5113

KEYNOTES

1. Vertical Datum: MLLW
Soundings in feet
2. Vertical Control:
Point 'SEI-1'
Elevation: 10.32 R.M.L.W.
641,832.045 N / 298,454.174 E
3. Horizontal Control:
Guam 1993 Coordinate System (feet)
Point 'SEI-2'
641,831.194 N / 298,500.441 E
Point 'SEI-3'
642,421.119 N / 298,031.385 E
4. Survey Controls set by
Generalsimo A. Vidales
Registered Land Surveyor
5. Survey Dates: 05-14-09 and 05-15-09
6. Survey performed to standards of the
U.S. Army Corps of Engineers
Hydrographic Surveying Manual
EM 1110-2-1003
7. Survey Instrumentation:
Coda Octopus multibeam echo-sounder
C-MAY GPS positioning
8. Soundings are:
a. Averaged over 1-meter (3.28-foot) cells.
b. Gauged by spherulosis method to
5-metric (16.4-foot) radius.

PORT AUTHORITY OF GUAM
Hydrographic Survey
Apra Harbor, Guam
May, 2009
Sheet 2 of 2

REVISIONS	
NO.	REVISION

**Hydrographic Survey
Contours and Soundings**

CONTRACT: 20173 Guam Commercial Port
PROJECT: APR 09
SHEET: 2 OF 2
DATE: 5/15/09
SCALE: 1" = 100'
20173 Guam Port Hydrographic Survey



N 643,500

N 643,000

N 642,500

N 642,000

N 641,500

N 641,000

E 291,500

E 292,000

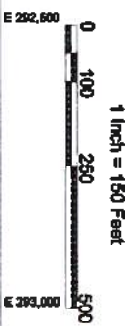

E 292,500

E 293,000

E 293,500

E 294,000

E 294,500

E 295,000

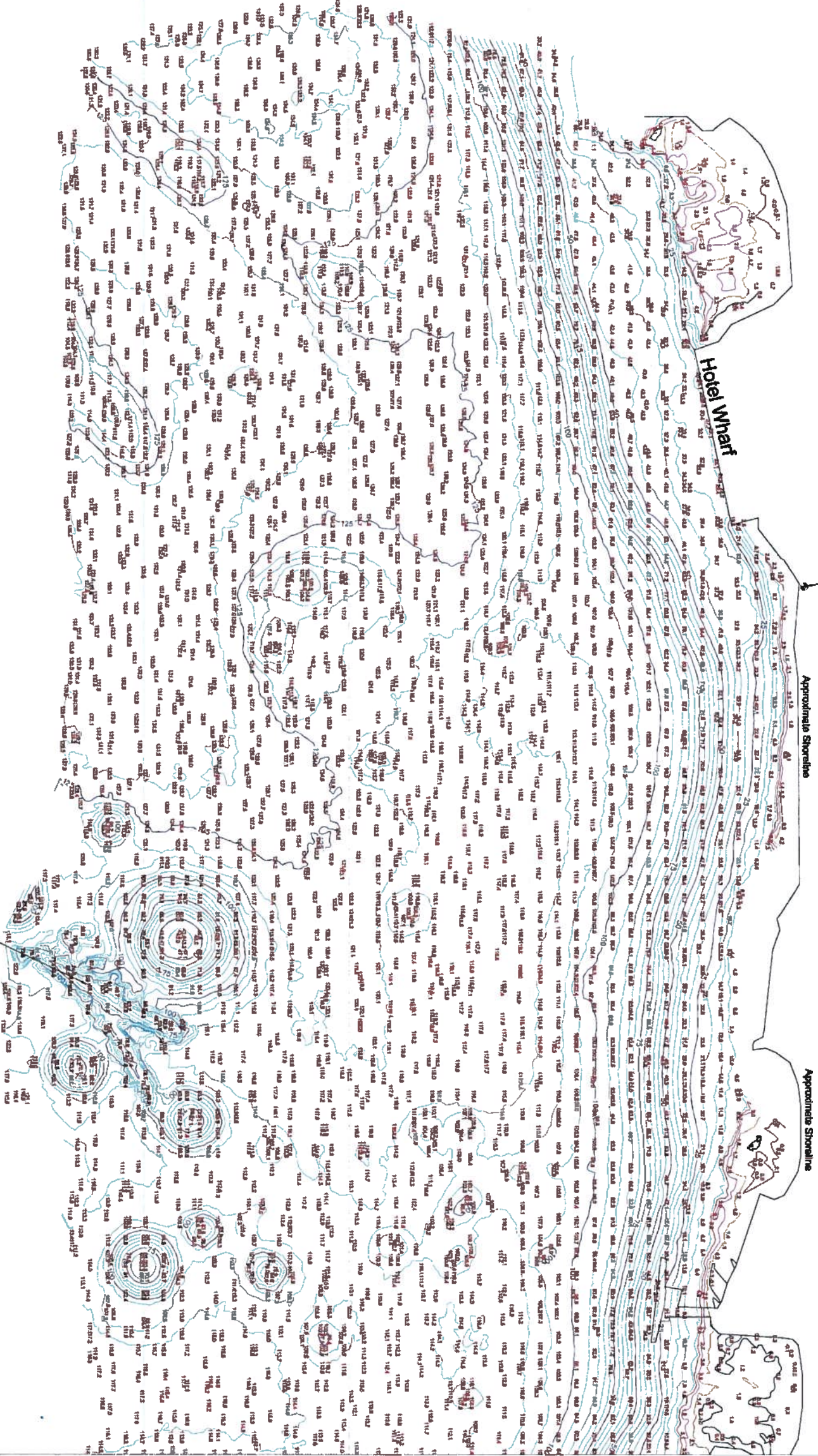

Point C-10*
643,282.27 N
293,815.98 E
Elevation: 14.08 ft MLLW

Approximate Shoreline

Approximate Shoreline

Wreck of the Common and Totei Men

I, FRANCISCO R. BALAGUA, hereby certify that this SURVEY was conducted by me or under my direct supervision, that it is based on a REED SURVEY MADE ON FEBRUARY 2, 2011.

(Signature)
3-23-11
FRANCISCO R. BALAGUA
DATE
PROFESSIONAL LAND SURVEYOR # 82



SYMBOL	MEANING
(Symbol)	10 FATHOM
(Symbol)	20 FATHOM
(Symbol)	30 FATHOM
(Symbol)	40 FATHOM
(Symbol)	50 FATHOM

REMARKS

1. Vertical Datum: MLLW
Soundings in feet

2. Vertical Control: Based on GDM 1986.
Point 'Cadena Baluar'
Elevation: 1027 ft MLLW

3. Horizontal Control:
Elevn: 1980 Contours (Datum Feet)

Point 'Cadena Baluar'
643282.26 N / 293815.98 E

Point 'C-10*'
643282.27 N / 293815.98 E

4. Survey Conducted by:
Francisco Balagua & Associates, Inc.,
Registered Land Surveyor

5. Survey Dates: 02-01-11, 02-02-11, 02-03-11

6. Survey performed to standards of the
U.S. Army Corps of Engineers
Hydrographic Surveying Manual,
EA 1110-3-1002.

7. Survey Instrumentation:
Ocean Surveyor medium auto-sounder
C-Max GPS positioner,
Ocean 200 PDS echo-sounder

8. Soundings are:
A. Averaged over 30-sec. cells.
B. Depth by pressure method to
D. 0.1m cell

9. Soundings are approximate. For reference only.

10. Contour Interval: 5 feet for water depths greater than
5 feet, 1 foot for water depths of 1 to 5 feet.

11. This measurement is not project control (ICM 1090)
except at NOAA Aids Marker 'Totoi Station'
163000L.

PORT AUTHORITY OF GUAM
Hydrographic Survey
Apra Harbor, Guam
February 2011

NO.	DATE	REVISION

Hydrographic Survey
Contours and Soundings

DATE: 2011-02-23
TIME: 14:30
DRAWN BY: F. BALAGUA
CHECKED BY: F. BALAGUA
SCALE: 1" = 150'
SHEET 1 OF 2
2012 Ocean Design, Inc.

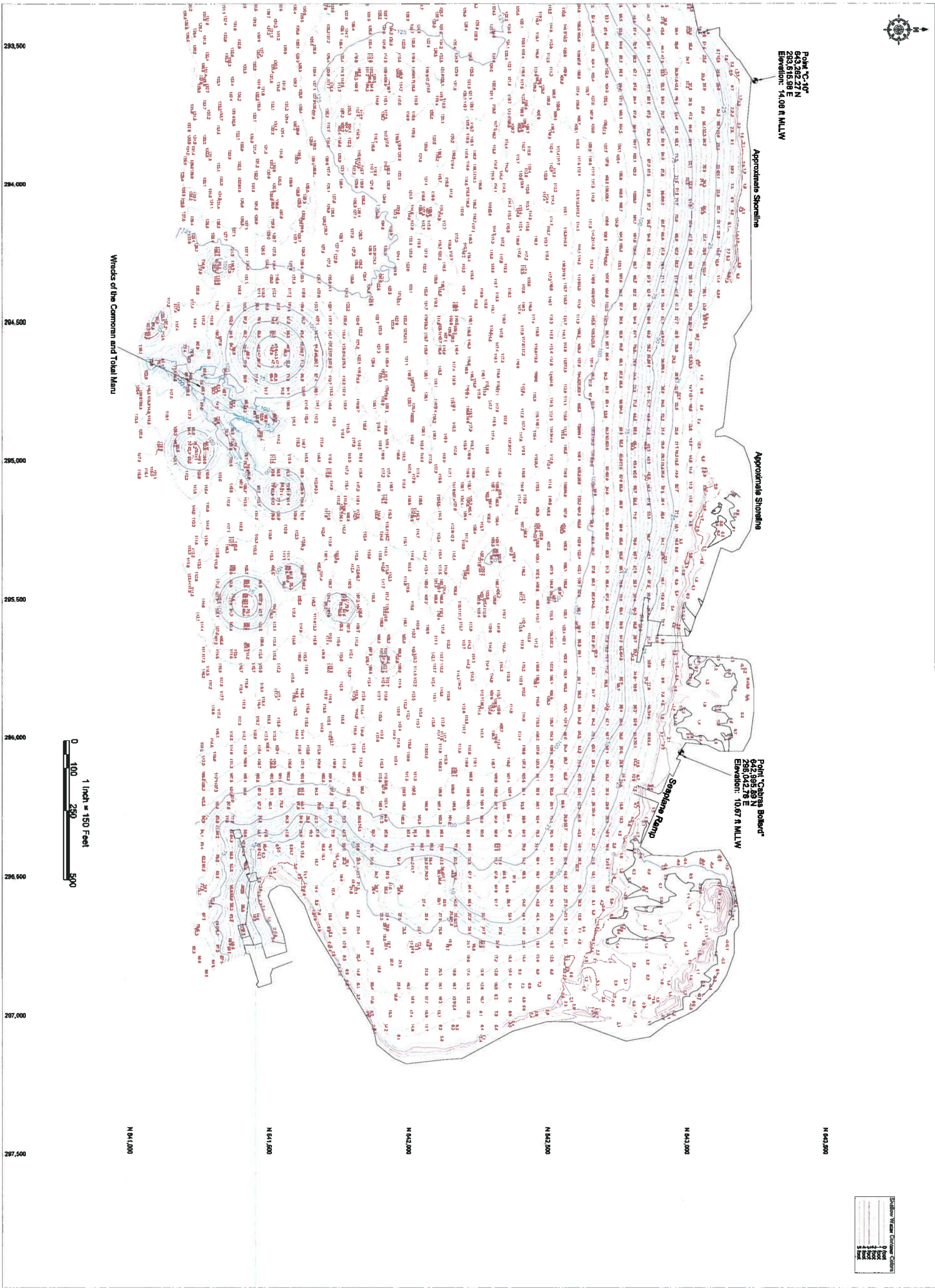

Point "C-10"
643,262.27 N
283,615.98 E
Elevation: 14.08 ft MLLW

Approximate Shoreline

Approximate Shoreline

Point "C-10B"
643,262.28 E
Elevation: 10.67 ft MLLW

Seseana Ramp

Wrecks of the Camoran and Tokai Maru

0 100 250 500
1 inch = 150 Feet

SHORELINE WRECK COASTLINE CHANGES

1	Original
2	Survey
3	Revised



Sea Engineering, Inc.
MARINE RESEARCH INC.
1000 S. 28th Ave. #200
Miami, FL 33133

KEYNOTES

- Vertical Datum: MLLW
Soundings in feet
- Vertical Control: Based on CGN 1986:
Point "Camaran Island"
Elevation: 10.67 ft MLLW
- Horizontal Control:
Guam 1983 Coordinate System (FGW)
Point "Tokai Maru"
642955.69 N / 289042.78 E
Point "C-10"
643262.27 N / 283615.98 E
- Survey Control and by
Regulatory Land Survey
- Survey Dates: 02-01-11, 02-02-11, 02-06-11
- Survey performed in accordance of the
U.S. Army Corps of Engineers
Hydrographic Surveying Manual,
EM 1190-5-1000
- Survey Instrumentation:
Ocean Stationer multibeam echosounder
C-Hey GPS positioning
Ocean 200 R/C echosounder
B. Soundings are:
a. Arranged over 2-foot cells,
b. Sounded by standard method to
50-foot cell.
B. Shoreline is approximate. For reference only
- Depth Interval: 5 feet for water depths greater than
10 fathoms. 1 foot for water depths of 1 to 9 fathoms.
- The measurements from project control (GDA 1986)
are approximately 0.4 ft higher than tide levels
as recorded at NOAA Apra Harbor Tide Station
1600000.

PORT AUTHORITY OF GUAM
Hydrographic Survey
Apra Harbor, Guam
February 2011

NO.	DATE	REVISION

Hydrographic Survey
Contours and Soundings

02/06/2011
SURVEYED BY: CAROL ANN COOPER
DRAWN BY: CAROL ANN COOPER
CHECKED BY: CAROL ANN COOPER
SCALE: 1" = 150' FT
SHEET 2 OF 2
PROJECT: APR HARBOR HYDROGRAPHIC SURVEY

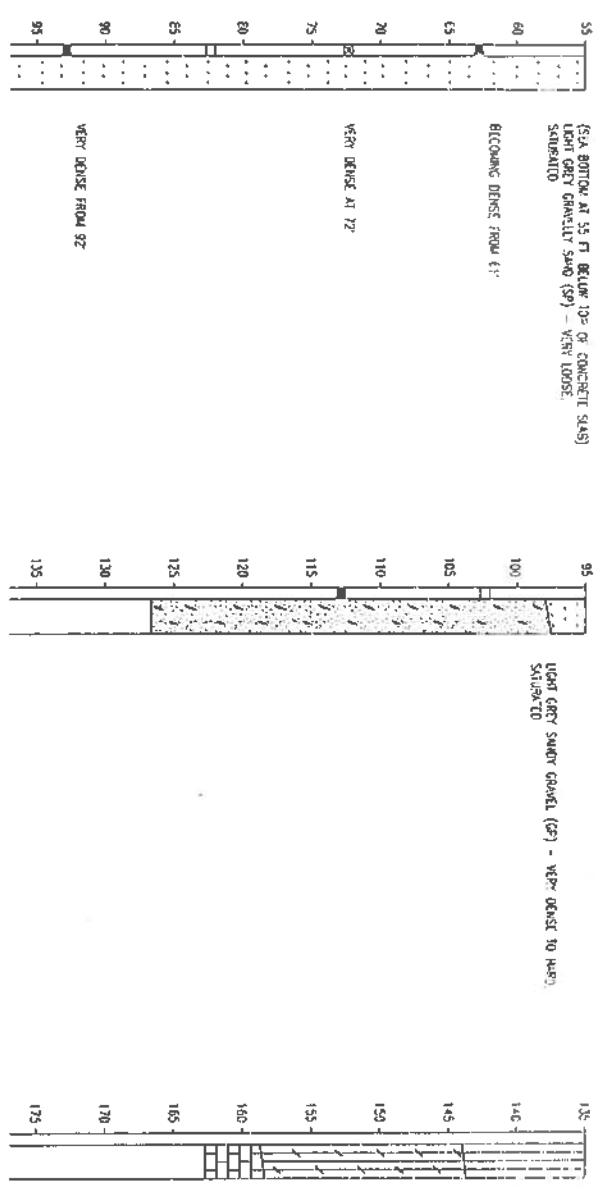

2 BORING LOG 1
C-1 SCALE
1" = 20'-0"

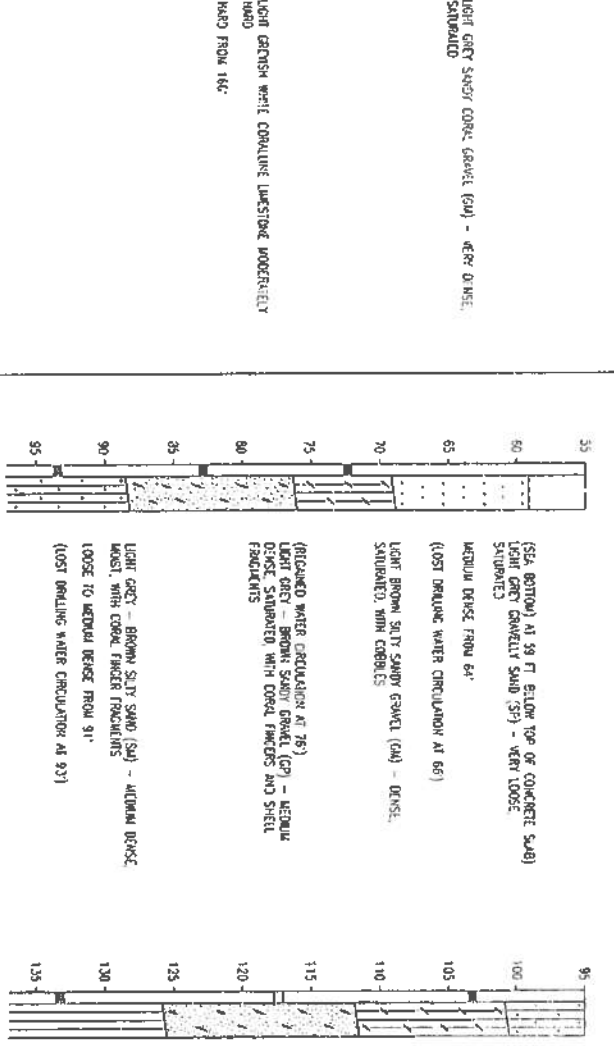

3 BORING LOG 2
C-1 SCALE
1" = 20'-0"

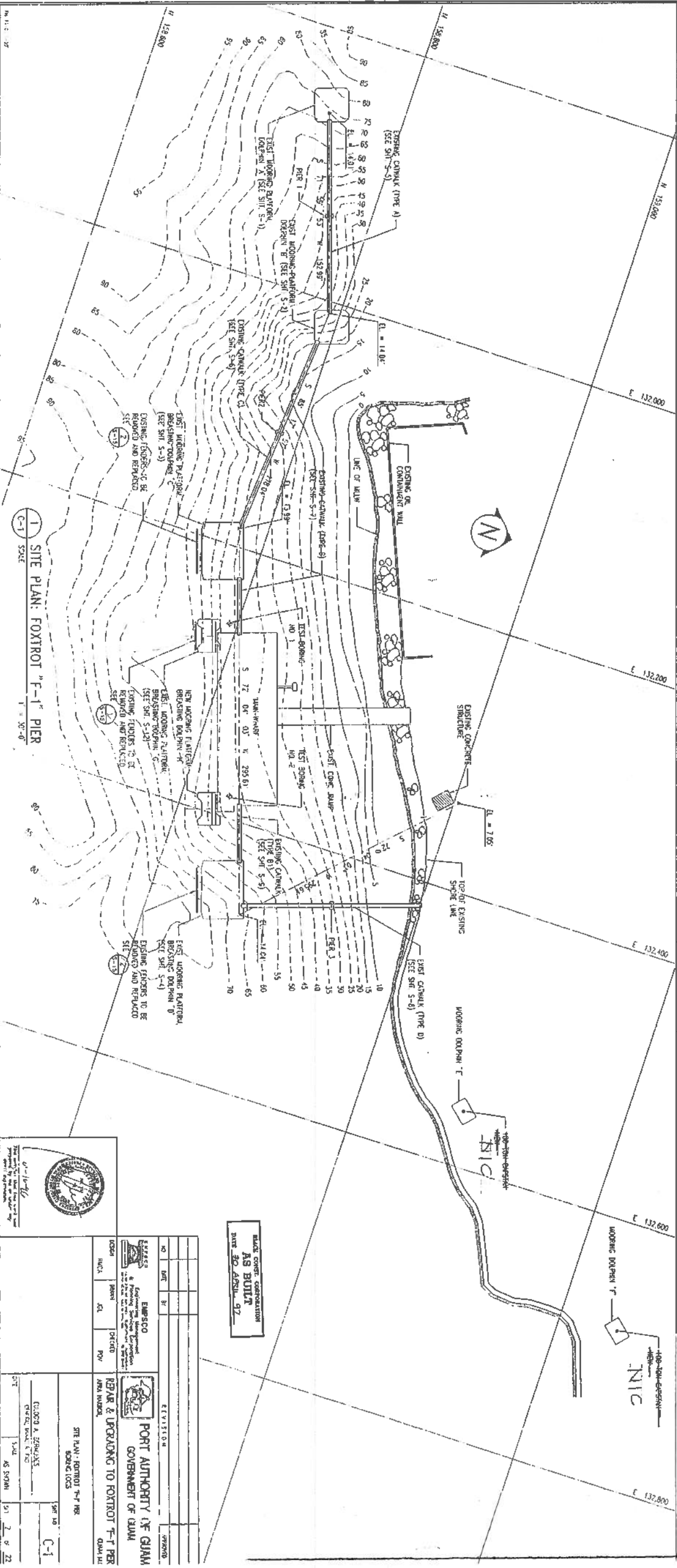

1 SITE PLAN: FOXTROT 'F-1' PIER
C-1 SCALE
1" = 20'-0"

MADE CONCRETE SUBSTITUTION
DATE 30 APRIL 97



NO.	DATE	BY	REVISION

DESIGN	HECK	ADL	PER	CHUCK	POW
PORT AUTHORITY OF GUAM GOVERNMENT OF GUAM REPAIR & UPGRADE TO FOXTROT 'F-1' PIER QUAD 142					
SITE PLAN: FOXTROT 'F-1' PIER BORING LOGS					
PREPARED BY CLAYTON A. ZEMLAK CIVIL ENGINEER, P.E.					
DATE: 26 SEP 96					
SHEET NO. C-1					
TOTAL SHEETS: 27					

AGANA MARINA HYDROGRAPHIC SURVEY

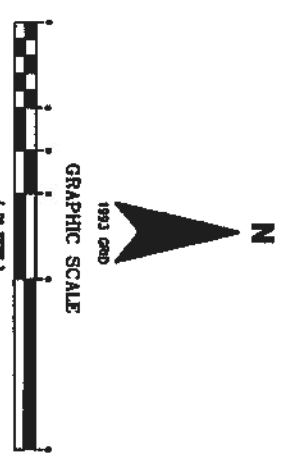
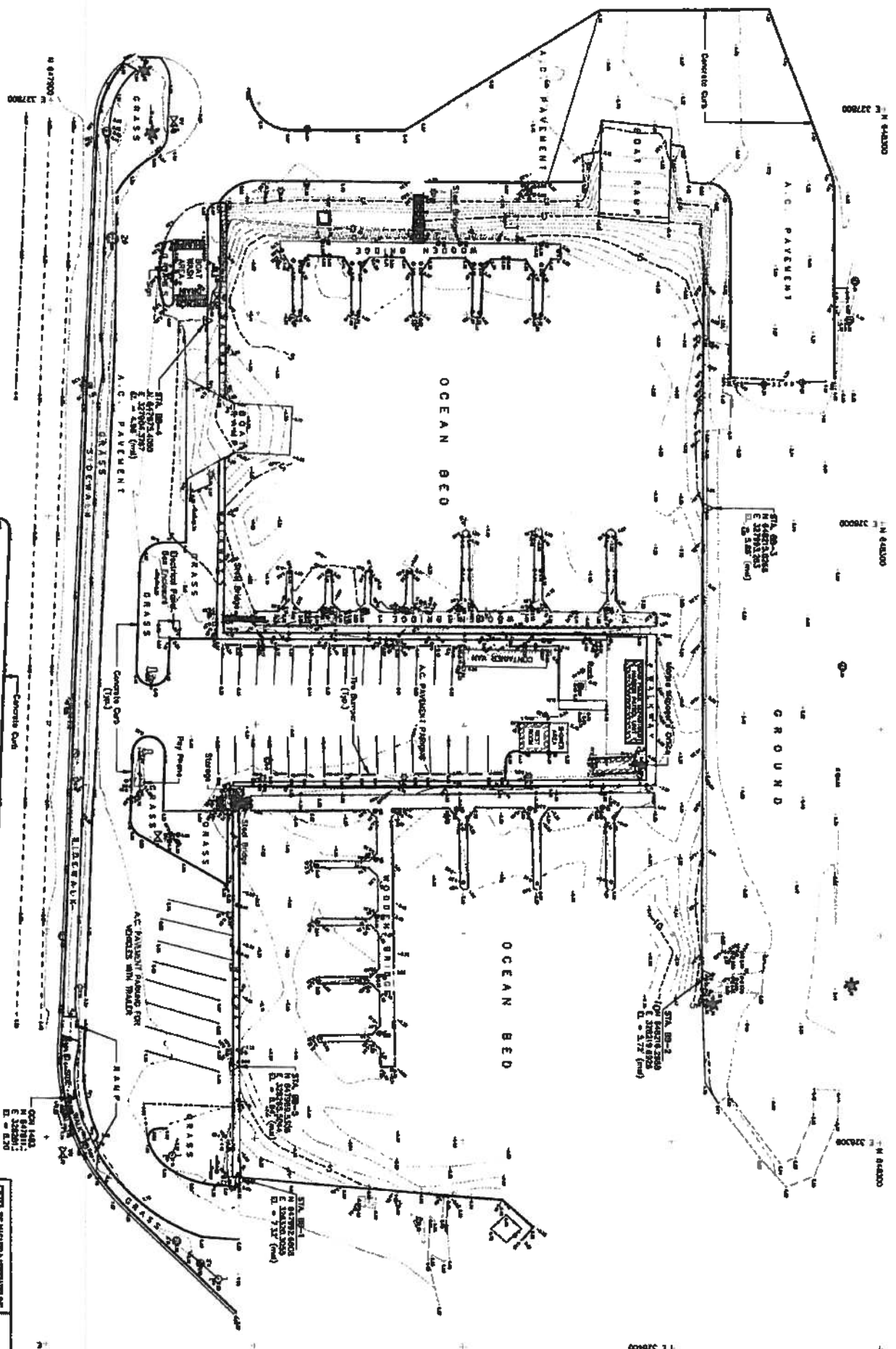

ABBREVIATIONS/ SYMBOLS/LEGEND

- A.C. ASPHALT CONCRETE
- BURIED CABLE
- CHAIN LINK FENCE
- CONCRETE SLAB/PAD
- A.C. PATCH
- CONCRETE PATCH
- CONTOUR ELEVATION
- EDGE OF A.C. ROAD
- ROAD CENTERLINE
- WHITE LINE
- FIRE HYDRANT
- GATE POST
- LIGHT POST
- 8" STEEL POST
- 6" STEEL POST
- GUARD POST
- ROAD SIGN
- SPOT ELEVATION
- SEWER MANHOLE
- ELECTRICAL MANHOLE
- MANHOLE
- CB
- CATCH BASIN
- TRANSFER STATION
- COIL ADJUMENT
- WATER VALVE
- WATER METER
- LATE STONE
- TRAFFIC LIGHT POST
- SEWER CLEAN OUT
- HOSE BIBB
- TIE ANCHOR
- CONCRETE POWER POLE
- WOODEN POWER POLE
- UTILITY POLE
- GUY WIRE
- COCKPIT TREE
- OTHER TREES

1 TOPOGRAPHIC/HYDROGRAPHIC SURVEY
SCALE 1"=200'-0"

AS BUILT PLAN

		PORT AUTHORITY OF GUAM GOVERNMENT OF GUAM	
RECOMMENDED FOR APPROVAL DATE: _____	SUPERVISOR OF U.S. SURVEY ENGINEERING DIVISION APPROVED BY: _____ DATE: _____	DESIGNED BY: RAYMOND B. PEREZ, MAJOR RECONSTRUCTION & PROJECTS & BRIDGE MAINTENANCE	SHEET NO.: 1-2 SHEET TOTAL: 1 OF 18
DRAWN BY: _____ CHECKED BY: _____ DATE: _____	SCALE: AS SHOWN	NAME: R. LUIS GARCIA & ASSOCIATES, INC. CIVIL ENGINEERS	DATE: _____

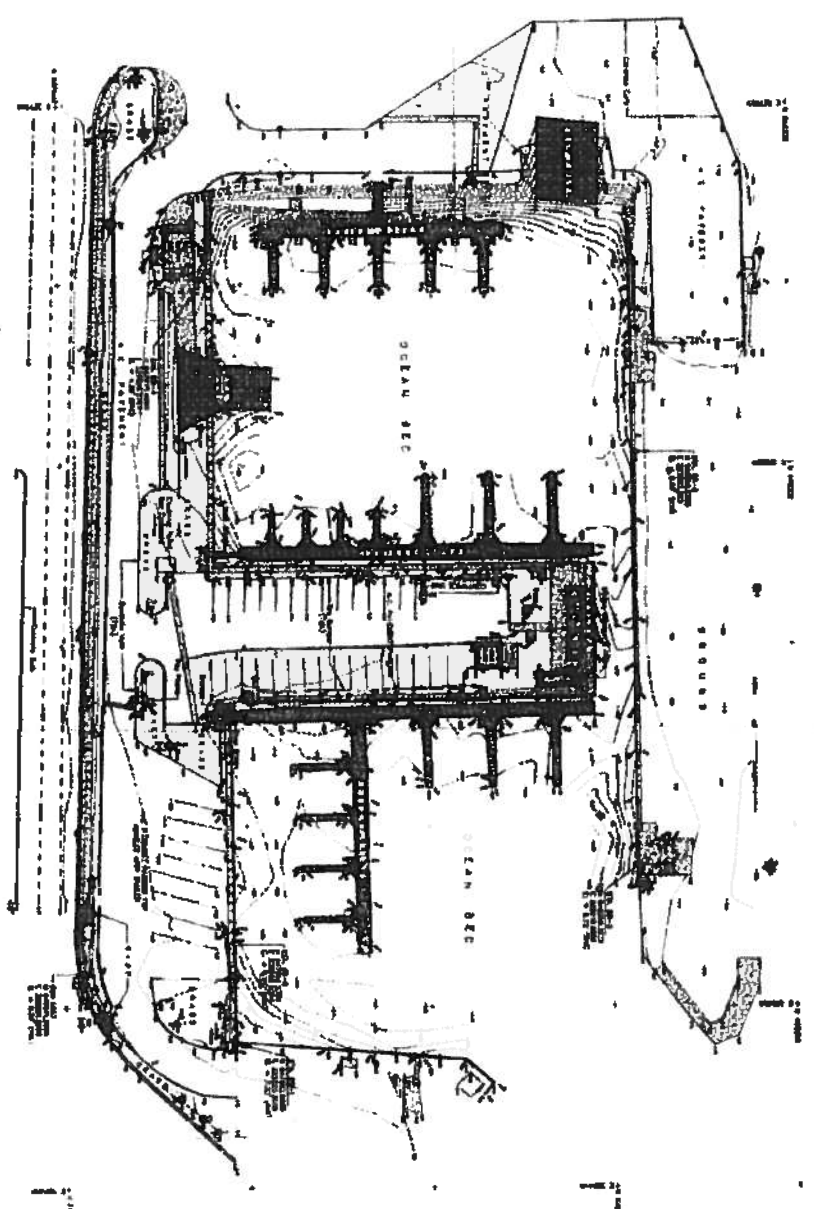

GRAPHIC SCALE
1" = 50'

ABBREVIATIONS / SYMBOLS / LEGEND

- 1. WATER
- 2. SAND
- 3. GRAVEL
- 4. ROCK
- 5. CONCRETE
- 6. STEEL
- 7. WOOD
- 8. BRICK
- 9. PLASTER
- 10. PAINT
- 11. ASPHALT
- 12. GRAVEL
- 13. SAND
- 14. ROCK
- 15. CONCRETE
- 16. STEEL
- 17. WOOD
- 18. BRICK
- 19. PLASTER
- 20. PAINT
- 21. ASPHALT
- 22. GRAVEL
- 23. SAND
- 24. ROCK
- 25. CONCRETE
- 26. STEEL
- 27. WOOD
- 28. BRICK
- 29. PLASTER
- 30. PAINT
- 31. ASPHALT
- 32. GRAVEL
- 33. SAND
- 34. ROCK
- 35. CONCRETE
- 36. STEEL
- 37. WOOD
- 38. BRICK
- 39. PLASTER
- 40. PAINT
- 41. ASPHALT
- 42. GRAVEL
- 43. SAND
- 44. ROCK
- 45. CONCRETE
- 46. STEEL
- 47. WOOD
- 48. BRICK
- 49. PLASTER
- 50. PAINT

OF
TOPOGRAPHIC SURVEY MAP
AGANA BOAT BASIN
MUNICIPALITY OF HAGATNA

PREPARED BY: [Signature]
DATE: [Date]

SCALE: 1" = 50'

PROJECT NO.: [Number]

DATE OF SURVEY: [Date]

DATE OF PLOTTING: [Date]

DATE OF PRINTING: [Date]

PROJECT NO.: [Number]

DATE OF SURVEY: [Date]

DATE OF PLOTTING: [Date]

DATE OF PRINTING: [Date]

AGANA MARINA HYDROGRAPHIC SURVEY

TOPOGRAPHIC HYDROGRAPHIC SURVEY
SCALE 1" = 50'

REVISION	NO.	DATE	DESCRIPTION	BY	CHECKED
	A				

PORT AUTHORITY OF GUAM
GOVERNMENT OF GUAM

RECOMMENDED FOR APPROVAL
[Signature]
DATE: [Date]

CHIEF ENGINEER
[Signature]
DATE: [Date]

TOPOGRAPHIC AND HYDROGRAPHIC SURVEY

PROJECT NO.: [Number]
DATE OF SURVEY: [Date]
DATE OF PLOTTING: [Date]
DATE OF PRINTING: [Date]

PROJECT NO.: [Number]
DATE OF SURVEY: [Date]
DATE OF PLOTTING: [Date]
DATE OF PRINTING: [Date]

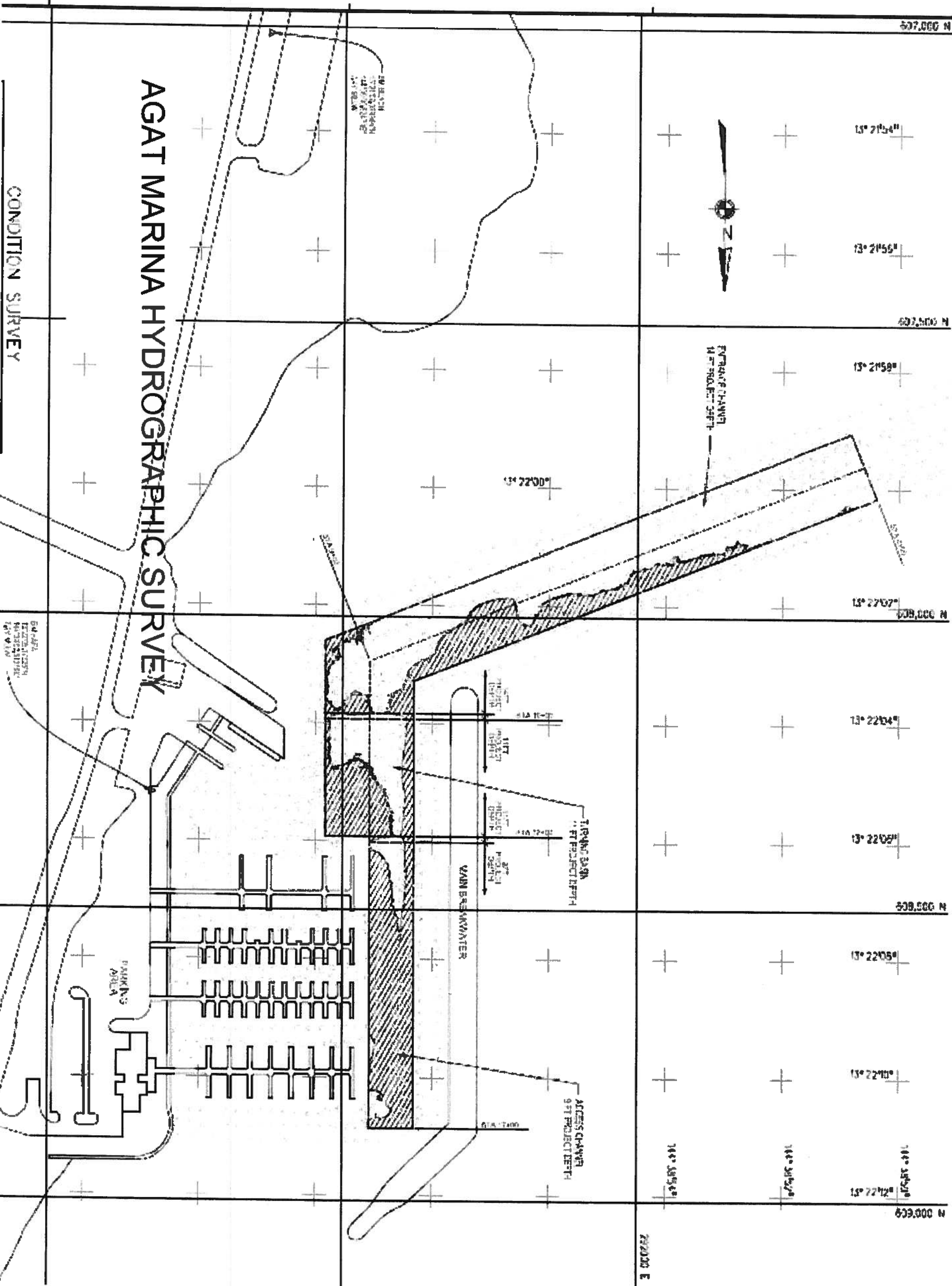



AQUAWORLD MARINA SITE PLAN